



**MODEL & PART NOS.:**

**RPH-208-A** (08845039)  
**RPH-240-A** (08845139)



**WARNING!** DO NOT ATTEMPT TO INSTALL, OPERATE, OR SERVICE THIS PRODUCT BEFORE READING ALL INSTRUCTIONS CAREFULLY. FAILURE TO COMPLY WITH THESE INSTRUCTIONS COULD RESULT IN FIRE, PERSONAL INJURY AND/OR PROPERTY DAMAGE! RETAIN INSTRUCTIONS FOR FUTURE REFERENCE.

**DESCRIPTION**

The Fostoria Restaurant Patio Heaters offer high efficiency electric infrared heat. All models are UL and CUL listed. Recommended for commercial / industrial indoor spot heating and for unprotected outdoor applications. The specially designed aluminum reflectors and end caps deliver infrared heat in a precise pattern to areas such as seating for outdoor dining or other patio uses.

**Not for indoor residential use.**

**REQUIRED CLEARANCES**

Do not install heater closer than 24 inches to a vertical surface, 6 inches to ceiling or 72 inches from floor or any combustible surface in direct radiation path.

**SPECIFICATIONS**

*Power requirements*.....RPH-208-A: 208 Volts, 7.69 Amps  
 RPH-240-A: 240 Volts, 6.67 Amps  
*Watts*.....1600  
*BTUs*.....5461  
*Overall dimensions*.....24" x 5-3/8" x 4-1/2"  
*Housing*.....Stainless steel  
*Reflector*.....Bright aluminum  
*UL file number*.....E32304

**UNPACKING**

When unpacking, inspect carefully for any damage that may have occurred during transit. Check for loose, missing, or damaged parts. (See parts list.)

**IMPORTANT SAFETY INFORMATION**

**Read all instructions before using this heater.**

1. Make certain that the power source conforms to the electrical requirements of the heater. Disconnect power before installing or servicing. If the power disconnect is out-of-sight, lock it in the open position and tag it to prevent unexpected application of power. Failure to do so could result in fatal electric shock. **WARNING: DO NOT DEPEND UPON A THERMOSTAT OR OTHER SWITCH AS THE SOLE MEANS OF DISCONNECTING POWER WHEN INSTALLING OR SERVICING THE HEATER. ALWAYS DISCONNECT BREAKER AS DESCRIBED ABOVE. FAILURE TO DO SO COULD RESULT IN FATAL ELECTRIC SHOCK.**
2. This heater is intended ONLY for permanent installation in accordance with the National Electric Code (NEC), all applicable local codes and ordinances, and all sections of this manual. Any variance voids the warranty and may create unsafe conditions. All wiring should be done by a qualified electrician, using copper wire only.
3. Special attention must be given to any bonding\* (grounding) information pertaining to this heater. To prevent the risk of electrocution, the heater must be securely and adequately bonded. This should be accomplished by connecting a conductor between the service panel and the green grounding screw provided on the heater. To ensure a proper bond, the bonding means must be tested by a qualified electrician.
4. Do not insert fingers or foreign objects into the heater. Do not block or tamper with the heater while it is in operation. Do not touch heater while it is in operation or just after it has been turned off, as some parts may be hot enough to cause injury.
5. This heater is intended for general heating applications ONLY. It must NOT be used in potentially dangerous locations such as flammable, explosive or chemical-laden atmospheres.
6. Do not attach ductwork to this heater or attempt to use it as a make-up air heater. Such use voids the warranty and may create unsafe conditions.
7. In cases where property damage may result from malfunction of the heater, a back-up system or a temperature alarm should be used.
8. CAUTION: Check branch voltage. Heaters should be operated at voltages no higher than the heating elements and the heater are designed for. (Lower voltages, however, pose no problem other than a loss of wattage).
9. Heaters are not intended for process heating applications.

**SAVE THESE INSTRUCTIONS!**

\*Bonding is the term that describes the completion of the electrical circuit back to its source, which allows a breaker or fuse to clear if a short occurs in the line.

# CAUTION

## POSSIBLE LAMP FAILURE

The heating elements used in this product can be damaged by contamination (salt deposits from perspiration or coastal air) on the surface of the quartz sleeve. At high temperatures, these salts will cause the quartz to become porous and leak allowing air to come in contact with the tungsten element. When this occurs, the element will burn out quickly and the quartz tube can break. The instructions below must be followed.

- Always wear cotton or latex gloves when installing or replacing elements.
- Always clean the quartz tube with an alcohol-moistened soft cloth before using the heater.
- Whenever contamination (milky white appearance on quartz tube) is observed, the element must be immediately replaced.

## LAMP INSTALLATION

**CAUTION:** Disconnect power before installing or replacing lamps. They can, and should be, installed prior to mounting heater.

1. Remove the housing end caps.
2. Position quartz lamp in slots in lamp brackets at each end of reflector.
3. Carefully wrap heating element pigtail clockwise around terminal screw (see figure A). Avoid handling quartz lamp as much as practical. Lamp should be wiped off with a clean cloth.
4. Tighten terminal screws (see figure A). **CAUTION:** Do not draw pigtail so tight that pressure is put on heating element. Maintain a partial loop (or looseness) in the pigtail.

**5. IMPORTANT!** Cut excess pigtail off at terminal to prevent lead from touching metal parts. Failure to do so could result in fatal electric shock or fire.

6. Replace end caps using sheet metal screws

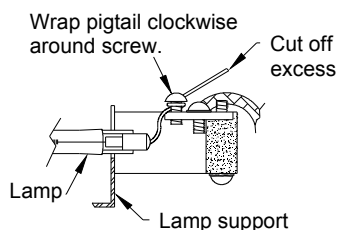
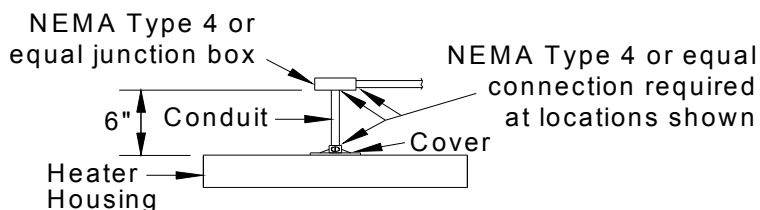

FIGURE "A"

## MOUNTING INSTRUCTIONS

1. Assemble the supplied outlet box cover to the top of the heater using the two hex head screws.
2. Route the two black leads and the green (bonding) lead through a section of 6" conduit (supplied by customer) and thread it into the cover.
3. Attach an outlet box cover to the other end of the conduit, make electrical connections and attach cover to customer supplied junction box.

**CAUTION:** FOR TOTALLY EXPOSED OUTDOOR APPLICATIONS (NOT CEILING PROTECTED) THE CONNECTONS MUST BE MADE AS ILLUSTRATED BELOW.



## WIRING

**CAUTION:** For supply connections use number 12 AWG copper wires suitable for at least 90°C.

## LAMPGUARD INSTALLATION

To install the optional lampguard (Model RPHWG):

1. Remove the screws and end cap from one end of the heater.
2. Insert the lampguard into the holes provided in each end cap.
3. Replace the end cap and screws removed in step 1. (See illustration below.)

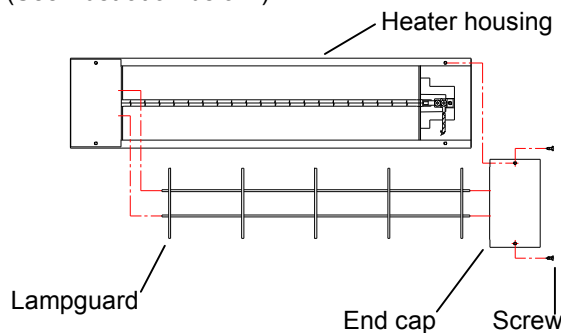

## MAINTENANCE

**Always disconnect the heater from the power source before performing any service or maintenance.**

Periodically clean the reflector with a soft damp cloth, using a mild detergent. Rinse with water and wipe dry with a clean soft cloth.

# REPLACEMENT PARTS LIST and EXPLODED VIEW

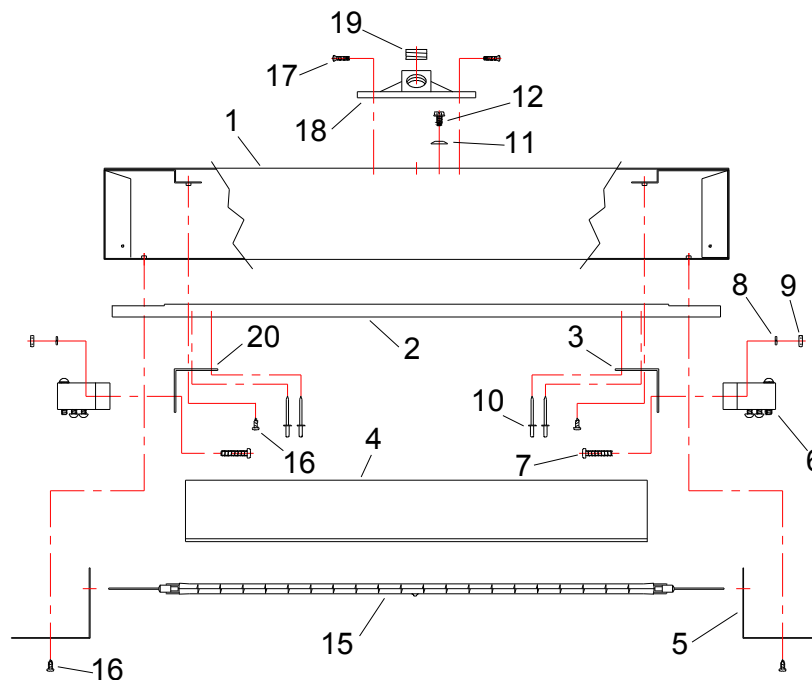

REF. NO.	DESCRIPTION	PART NUMBER	QTY.
1	Housing	3930139	1
2	Wire way	8051300	1
3	Lamp bracket	8051200	1
4	Reflector	8051500	1
5	End cap	8051400	2
6	Socket assembly	8500003	2
7	Screw 10-32 x 1"	3401939	4
8	Lock washer #10	3466039	4
9	Hex nut 10-32	3405239	4
10	Pop rivet	3482200	4
11	Curved washer	3476700	1
12	Screw 10-32 x 3/8"	3475000	1
13	Wire assembly 20" (not shown)	3160704	1
14	Wire assembly 32" (not shown)	3160603	2
15	Lamp 208 volt	6321620	1
	Lamp 240 volt	6321624	1
16	Screw 6-32 x 3/8"	2410700	8
17	Screw 8-32 x 1/2"	2401800	2
18	Outlet box cover	3111200	1
19	Closure plug 1/2"	2402000	2
20	Lamp bracket	8051200	1

## WARRANTY

FOSTORIA INDUSTRIES, INC. – 1200 North Main Street - Fostoria, Ohio 44830-1911 - (419) 435-9201

The warranty herein set forth is in lieu of all other warranties expressed or implied.

Fostoria Industries, Inc. of Fostoria, Ohio 44830, warrants its products to the owner against defects in material and workmanship for a twelve (12) month period under normal use and service following date of manufacture or installation when proof of such is provided to seller.

This Warranty requires that the owner, or his agent, install the equipment in accordance with the National Electrical Code, any other applicable heating or electrical codes and the manufacturer's installation instructions. It further requires that he perform reasonable and necessary maintenance on the unit. The company is not liable for abuse or misuse of product as may be finally determined by the company.

The obligation of Fostoria Industries, Inc. under the terms of this warranty, shall be to supply a new part, repair of defective part, or a refund, at the company's option with no cost to owner for the new or repaired part. Such parts are to be returned to the factory, or such other location as the company may designate. This warranty does not obligate Fostoria Industries, Inc. to bear the cost of labor in replacing any assembly, unit or component part thereof, nor does the company assume any liability for secondary charges, expenses for installing or removal, or any other consequential losses. The company's maximum liability shall not in any case exceed the list price for the product claimed to be defective.

The warranty shall not apply to any product or parts of products which have been repaired or altered outside of Seller's factory in any manner. Warranty is void on products that have been determined to have been subjected to misuse, negligence or accident or which have been used in a manner contrary to Seller's instructions.